



## Thermoelectric cooling unit TG 3030-12V



### Product Features

<b>Brand Name:</b>	SoliTherm Peltier
<b>Order Number:</b>	3030305
<b>Housing Material:</b>	Stainless steel AISI 304 (V2A)
<b>IP class EN 60529:</b>	IP 66
<b>Approvals:</b>	CE, RoHS
<b>Accessories:</b>	 <a href="#">Condensate Kit</a> 
<b>Taric Code:</b>	84158300

## Technical data TG 3030-12V

<b>Cooling capacity L35L35:</b>	30 W
<b>Temperature range:</b>	-20°C - +65°C
<b>Air volume flow:</b>	Ambient air circuit: 39 m <sup>3</sup> /h Cabinet air circuit: 20 m <sup>3</sup> /h
<b>Mounting:</b>	External (with frame)
<b>Dimension HxWxD:</b>	212 x 158 x 131 mm
<b>Weight:</b>	2.6 kg
<b>Cut out dimensions:</b>	180 x 128 mm
<b>Voltage / Frequency:</b>	12 V DC
<b>Current L35L35:</b>	2.8 A
<b>Starting current:</b>	4.3 A
<b>Max. current:</b>	2.9 A
<b>Nominal power L35L35:</b>	34 W
<b>Max. power:</b>	35 W
<b>Fuse:</b>	5 A (T)
<b>Connection:</b>	Connection terminal block

Please click on the graphics to download.  
 More CAD drawings can be found under [Product Download](#).  
 > [Overview product group Cabinet cooling units - Peltier](#)

**Performance Graph:**

T = Ambient temperature  
P = Cooling capacity

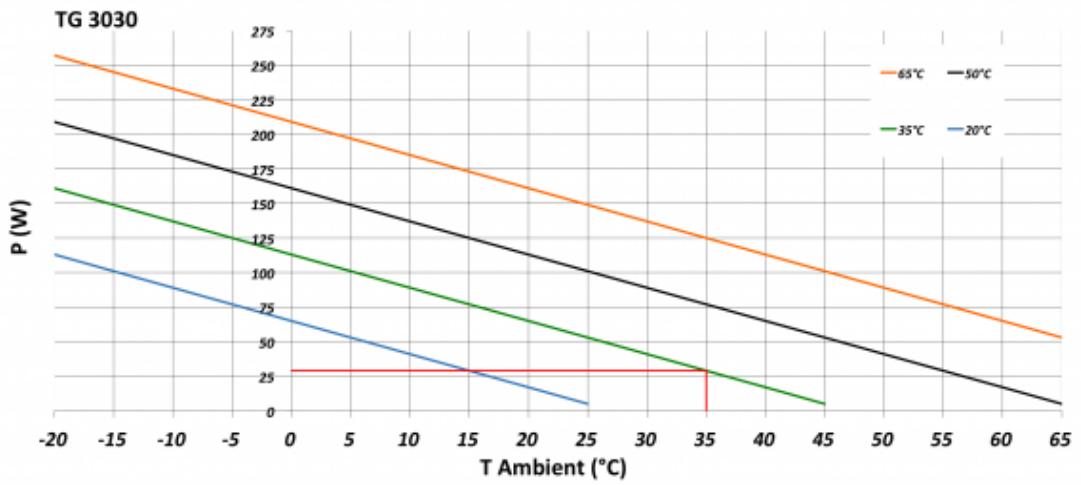

click image to enlarge

**Air flow:**

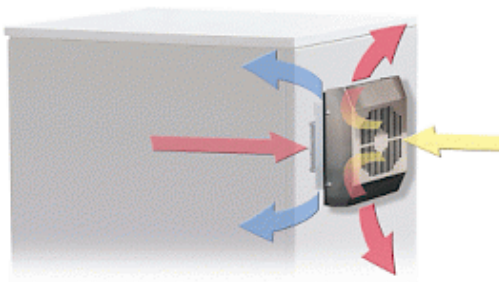

click image to enlarge

**Cut out dimensions:**

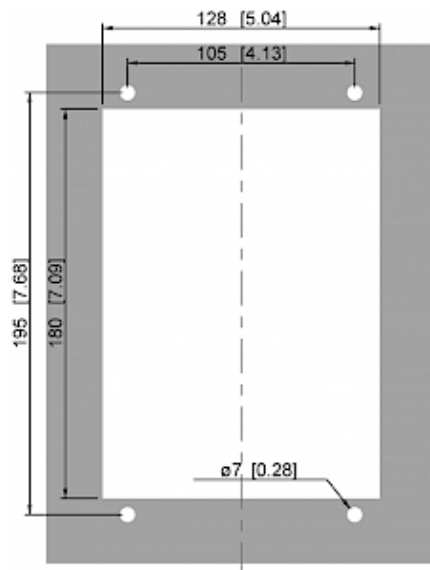

click image to enlarge