



Standard outdoor enclosure SZB IP 55

SZB – is a large wall-mounted or freestanding enclosure, characterized by high corrosion protection properties, for use in outdoor conditions. The standard offer includes 63 dimensions. Tables with catalogue numbers are available on the following pages of the catalogue.

Type	Corrosivity category	Material / additional description	Coating
SZB	C3	galvanized steel sheet	RAL7035
SZB-MG	C4	magnelis sheet	RAL7035
SZB-AL	C3*	aluminum sheet	RAL7035
SZB-OH	C4**	stainless steel 1.4301 (AISI 304)	BRUSHED
SZB-KO	C5-I (M)**	acid-proof steel 1.4404 (AISI 316L)	BRUSHED

General information:

- Ingress protection according to IP code: 55
- Impact resistance according to IK code: 10
- Operating temperature range: -30 – +80°C

Basic data:

- Body: with roof slope
- Closure: hinged door with 105° opening angle; the possibility of independent change of the door opening direction; lock in the form of a handle with the possibility of mounting a latch insert with a key
- Enclosures of 1000 mm width and more have double-leaf doors
- Mounting plate: in each version is made of 2 mm thick galvanized steel sheet, mounted on perforated brackets adjustable on the entire depth of the enclosure
- Cable entry: there is a gland plate in the bottom, its dimensions depend on the width of the enclosure
- Grounding: threaded grounding studs in the door and enclosure body
- Other information: The door has an internal stiffening made of perforated u-bars to facilitate mounting of additional elements.

Additional options:

- Thermal insulation
- Increase of the operating temperature range from -50 to +120°C
- Unusual dimensions
- Punching in the door, body or mounting plate
- Painting to any color according to the RAL palette



Download product data sheet!

Description	Page
Locks	91
Mounting plates	96
Vertical beams	100-101
Modular constructions	102-103
Internal doors	106-107
Plinths	115-116
Reinforced concrete foundations	129
Cable entry	119-121
Wall brackets	130
Ventilation	81
Heaters	82-83
Air conditioners	85-89

The technical documentation is available on pages 148-149

The following table presents enclosures equipped with a mounting plate.

No.	Dimensions (W × H × D mm)	Catalogue No. SZB	Catalogue No. SZB-MG	Catalogue No. SZB-AL	Catalogue No. SZB-OH	Catalogue No. SZB-KO
1	600 × 1400 × 300	126-001	126-401	126-101	126-201	126-301
2	600 × 1400 × 400	126-002	126-402	126-102	126-202	126-302
3	600 × 1600 × 300	126-003	126-403	126-103	126-203	126-303
4	600 × 1600 × 400	126-004	126-404	126-104	126-204	126-304
5	600 × 1800 × 300	126-005	126-405	126-105	126-205	126-305
6	600 × 1800 × 400	126-006	126-406	126-106	126-206	126-306
7	600 × 2000 × 300	126-007	126-407	126-107	126-207	126-307
8	600 × 2000 × 400	126-008	126-408	126-108	126-208	126-308
9	600 × 2000 × 500	126-009	126-409	126-109	126-209	126-309
10	600 × 2000 × 600	126-010	126-410	126-110	126-210	126-310
11	800 × 1400 × 300	126-011	126-411	126-111	126-211	126-311
12	800 × 1400 × 400	126-012	126-412	126-112	126-212	126-312
13	800 × 1600 × 300	126-013	126-413	126-113	126-213	126-313
14	800 × 1600 × 400	126-014	126-414	126-114	126-214	126-314
15	800 × 1800 × 300	126-015	126-415	126-115	126-215	126-315
16	800 × 1800 × 400	126-016	126-416	126-116	126-216	126-316
17	800 × 1800 × 500	126-017	126-417	126-117	126-217	126-317
18	800 × 1800 × 600	126-018	126-418	126-118	126-218	126-318
19	800 × 2000 × 300	126-019	126-419	126-119	126-219	126-319
20	800 × 2000 × 400	126-020	126-420	126-120	126-220	126-320
21	800 × 2000 × 500	126-021	126-421	126-121	126-221	126-321
22	800 × 2000 × 600	126-022	126-422	126-122	126-222	126-322
23	1000 × 800 × 250	126-023	126-423	126-123	126-223	126-323
24	1000 × 800 × 300	126-024	126-424	126-124	126-224	126-324
25	1000 × 800 × 400	126-025	126-425	126-125	126-225	126-325
26	1000 × 1000 × 250	126-026	126-426	126-126	126-226	126-326
27	1000 × 1000 × 300	126-027	126-427	126-127	126-227	126-327
28	1000 × 1000 × 400	126-028	126-428	126-128	126-228	126-328
29	1000 × 1200 × 250	126-029	126-429	126-129	126-229	126-329
30	1000 × 1200 × 300	126-030	126-430	126-130	126-230	126-330
31	1000 × 1200 × 400	126-031	126-431	126-131	126-231	126-331
32	1000 × 1400 × 300	126-032	126-432	126-132	126-232	126-332
33	1000 × 1400 × 400	126-033	126-433	126-133	126-233	126-333
34	1000 × 1600 × 300	126-034	126-434	126-134	126-234	126-334
35	1000 × 1600 × 400	126-035	126-435	126-135	126-235	126-335
36	1000 × 1800 × 300	126-036	126-436	126-136	126-236	126-336
37	1000 × 1800 × 400	126-037	126-437	126-137	126-237	126-337
38	1000 × 2000 × 300	126-038	126-438	126-138	126-238	126-338
39	1000 × 2000 × 400	126-039	126-439	126-139	126-239	126-339
40	1000 × 2000 × 500	126-040	126-440	126-140	126-240	126-340
41	1200 × 800 × 300	126-041	126-441	126-141	126-241	126-341
42	1200 × 800 × 400	126-042	126-442	126-142	126-242	126-342
43	1200 × 1000 × 300	126-043	126-443	126-143	126-243	126-343
44	1200 × 1000 × 400	126-044	126-444	126-144	126-244	126-344
45	1200 × 1200 × 300	126-045	126-445	126-145	126-245	126-345
46	1200 × 1200 × 400	126-046	126-446	126-146	126-246	126-346
47	1200 × 1400 × 300	126-047	126-447	126-147	126-247	126-347
48	1200 × 1400 × 400	126-048	126-448	126-148	126-248	126-348
49	1200 × 1600 × 300	126-049	126-449	126-149	126-249	126-349
50	1200 × 1600 × 400	126-050	126-450	126-150	126-250	126-350
51	1200 × 1800 × 300	126-051	126-451	126-151	126-251	126-351
52	1200 × 1800 × 400	126-052	126-452	126-152	126-252	126-352
53	1200 × 1800 × 500	126-053	126-453	126-153	126-253	126-353
54	1200 × 2000 × 300	126-054	126-454	126-154	126-254	126-354
55	1200 × 2000 × 350	126-055	126-455	126-155	126-255	126-355
56	1200 × 2000 × 400	126-056	126-456	126-156	126-256	126-356
57	1200 × 2000 × 500	126-057	126-457	126-157	126-257	126-357
58	1200 × 2000 × 600	126-058	126-458	126-158	126-258	126-358
59	1600 × 1800 × 400	126-059	126-459	126-159	126-259	126-359
60	1600 × 1800 × 500	126-060	126-460	126-160	126-260	126-360
61	1600 × 2000 × 400	126-061	126-461	126-161	126-261	126-361
62	1600 × 2000 × 500	126-062	126-462	126-162	126-262	126-362
63	1600 × 2000 × 600	126-063	126-463	126-163	126-263	126-363



SZB
IP 55

Scope of delivery:
Assembled enclosure without lock insert.

The following table presents empty enclosures.

No.	Dimensions (W × H × D mm)	Catalogue No. SZB-N	Catalogue No. SZB-MG-N	Catalogue No. SZB-AL-N	Catalogue No. SZB-OH-N	Catalogue No. SZB-KO-N
1	600 × 1400 × 300	127-001	127-401	127-101	127-201	127-301
2	600 × 1400 × 400	127-002	127-402	127-102	127-202	127-302
3	600 × 1600 × 300	127-003	127-403	127-103	127-203	127-303
4	600 × 1600 × 400	127-004	127-404	127-104	127-204	127-304
5	600 × 1800 × 300	127-005	127-405	127-105	127-205	127-305
6	600 × 1800 × 400	127-006	127-406	127-106	127-206	127-306
7	600 × 2000 × 300	127-007	127-407	127-107	127-207	127-307
8	600 × 2000 × 400	127-008	127-408	127-108	127-208	127-308
9	600 × 2000 × 500	127-009	127-409	127-109	127-209	127-309
10	600 × 2000 × 600	127-010	127-410	127-110	127-210	127-310
11	800 × 1400 × 300	127-011	127-411	127-111	127-211	127-311
12	800 × 1400 × 400	127-012	127-412	127-112	127-212	127-312
13	800 × 1600 × 300	127-013	127-413	127-113	127-213	127-313
14	800 × 1600 × 400	127-014	127-414	127-114	127-214	127-314
15	800 × 1800 × 300	127-015	127-415	127-115	127-215	127-315
16	800 × 1800 × 400	127-016	127-416	127-116	127-216	127-316
17	800 × 1800 × 500	127-017	127-417	127-117	127-217	127-317
18	800 × 1800 × 600	127-018	127-418	127-118	127-218	127-318
19	800 × 2000 × 300	127-019	127-419	127-119	127-219	127-319
20	800 × 2000 × 400	127-020	127-420	127-120	127-220	127-320
21	800 × 2000 × 500	127-021	127-421	127-121	127-221	127-321
22	800 × 2000 × 600	127-022	127-422	127-122	127-222	127-322
23	1000 × 800 × 250	127-023	127-423	127-123	127-223	127-323
24	1000 × 800 × 300	127-024	127-424	127-124	127-224	127-324
25	1000 × 800 × 400	127-025	127-425	127-125	127-225	127-325
26	1000 × 1000 × 250	127-026	127-426	127-126	127-226	127-326
27	1000 × 1000 × 300	127-027	127-427	127-127	127-227	127-327
28	1000 × 1000 × 400	127-028	127-428	127-128	127-228	127-328
29	1000 × 1200 × 250	127-029	127-429	127-129	127-229	127-329
30	1000 × 1200 × 300	127-030	127-430	127-130	127-230	127-330
31	1000 × 1200 × 400	127-031	127-431	127-131	127-231	127-331
32	1000 × 1400 × 300	127-032	127-432	127-132	127-232	127-332
33	1000 × 1400 × 400	127-033	127-433	127-133	127-233	127-333
34	1000 × 1600 × 300	127-034	127-434	127-134	127-234	127-334
35	1000 × 1600 × 400	127-035	127-435	127-135	127-235	127-335
36	1000 × 1800 × 300	127-036	127-436	127-136	127-236	127-336
37	1000 × 1800 × 400	127-037	127-437	127-137	127-237	127-337
38	1000 × 2000 × 300	127-038	127-438	127-138	127-238	127-338
39	1000 × 2000 × 400	127-039	127-439	127-139	127-239	127-339
40	1000 × 2000 × 500	127-040	127-440	127-140	127-240	127-340
41	1200 × 800 × 300	127-041	127-441	127-141	127-241	127-341
42	1200 × 800 × 400	127-042	127-442	127-142	127-242	127-342
43	1200 × 1000 × 300	127-043	127-443	127-143	127-243	127-343
44	1200 × 1000 × 400	127-044	127-444	127-144	127-244	127-344
45	1200 × 1200 × 300	127-045	127-445	127-145	127-245	127-345
46	1200 × 1200 × 400	127-046	127-446	127-146	127-246	127-346
47	1200 × 1400 × 300	127-047	127-447	127-147	127-247	127-347
48	1200 × 1400 × 400	127-048	127-448	127-148	127-248	127-348
49	1200 × 1600 × 300	127-049	127-449	127-149	127-249	127-349
50	1200 × 1600 × 400	127-050	127-450	127-150	127-250	127-350
51	1200 × 1800 × 300	127-051	127-451	127-151	127-251	127-351
52	1200 × 1800 × 400	127-052	127-452	127-152	127-252	127-352
53	1200 × 1800 × 500	127-053	127-453	127-153	127-253	127-353
54	1200 × 2000 × 300	127-054	127-454	127-154	127-254	127-354
55	1200 × 2000 × 350	127-055	127-455	127-155	127-255	127-355
56	1200 × 2000 × 400	127-056	127-456	127-156	127-256	127-356
57	1200 × 2000 × 500	127-057	127-457	127-157	127-257	127-357
58	1200 × 2000 × 600	127-058	127-458	127-158	127-258	127-358
59	1600 × 1800 × 400	127-059	127-459	127-159	127-259	127-359
60	1600 × 1800 × 500	127-060	127-460	127-160	127-260	127-360
61	1600 × 2000 × 400	127-061	127-461	127-161	127-261	127-361
62	1600 × 2000 × 500	127-062	127-462	127-162	127-262	127-362
63	1600 × 2000 × 600	127-063	127-463	127-163	127-263	127-363



SZB
IP 55

Scope of delivery:
Assembled enclosure without lock insert.

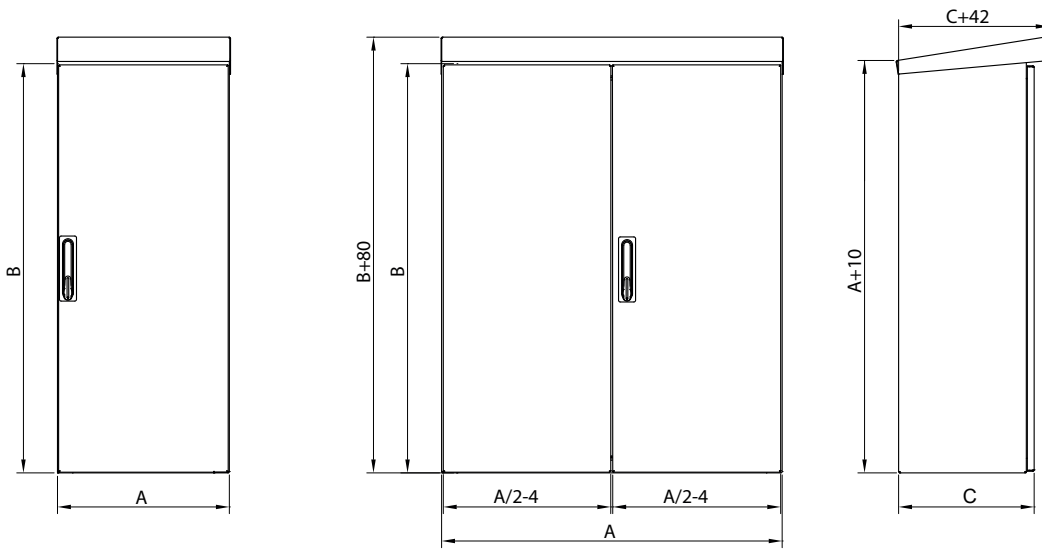

**CABLE GLAND PUNCHING
AS IN RSB ENCLOSURES**

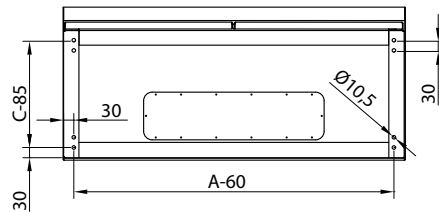

DOOR WITH PERFORATED STIFFENING FRAMES

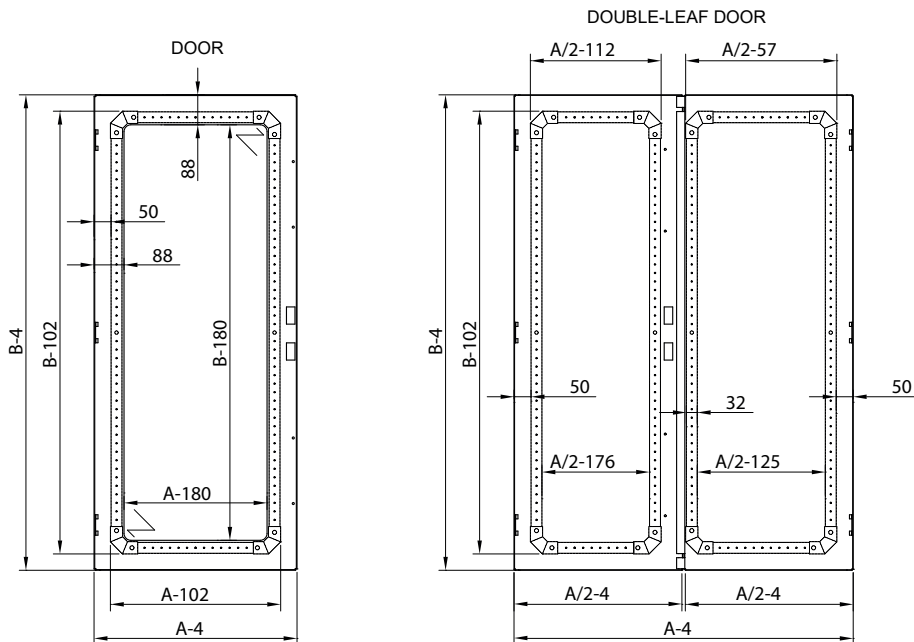

**MOUNTING PLATE VIEW
(WITHOUT DOOR)**

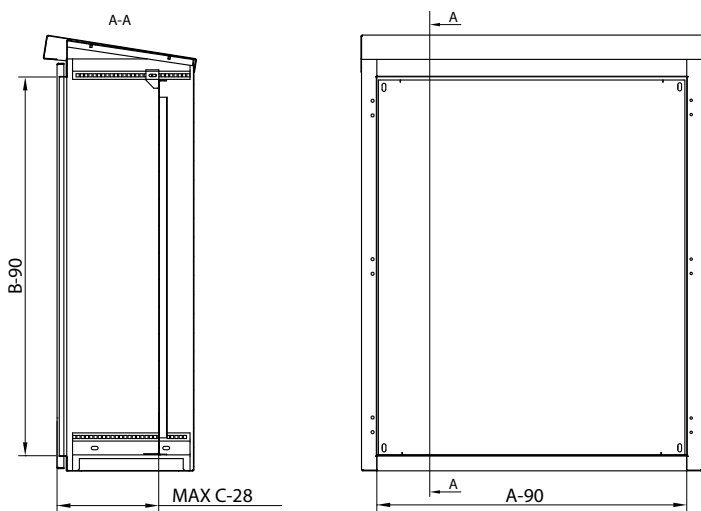

DISTANCE BETWEEN THE MOUNTING PLATE AND THE DOOR

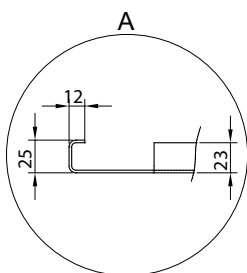

MOUNTING PLATE

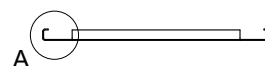
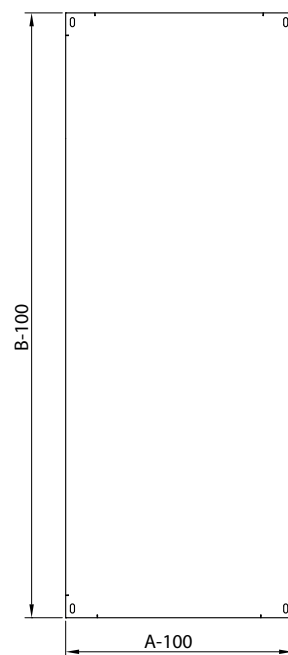

SELECT GLAND PLATES ACCORDING TO THE RSA GLAND PLATES TABLE



BOTTOM VIEW OF THE PLINTH

